



Lever Hoist

SLB Silver Series



For when you really need a lift

Ingersoll Rand SLB Silver Series lever hoists offer the ultimate in performance, durability, and safety for a variety of demanding applications. The high-strength, all-stamped steel construction offers decreased weight and better impact resistance. The automatic inertia brake engages if load is applied in free-chain mode, helping minimize operator setup error.

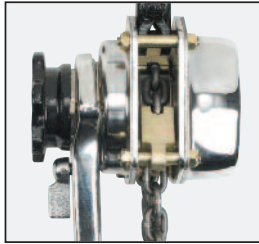

Double chain guides for proper load chain tracking and smooth operation around load sheave

CE Certified; hoists meet or exceed regional requirements including ASMEB30.21, HST-3M

Open frame design for easy cleaning and inspection

Encased and retained roller bearings for increased efficiency and ease of maintenance

Premium grade alloy load chain

Hardened swivel-latch hooks

Nickel / chrome-plated exterior and zinc-plated frame components for increased corrosion resistance

Double reduction gearing for superior spotting characteristics and low handle effort

Deep lug knobs for easy one-handed operation with or without gloves

Short handle and stroke allows 360-degree operation for rigging in tight spaces



SLB Silver Series lever hoists are ideal for these applications:

- Offshore drilling rigs
- Oil refineries and chemical plants
- Shipbuilding and shipyards
- Mining
- Utilities
- Steel mills and foundries
- General construction
- Maintenance and repairs
- Rigging

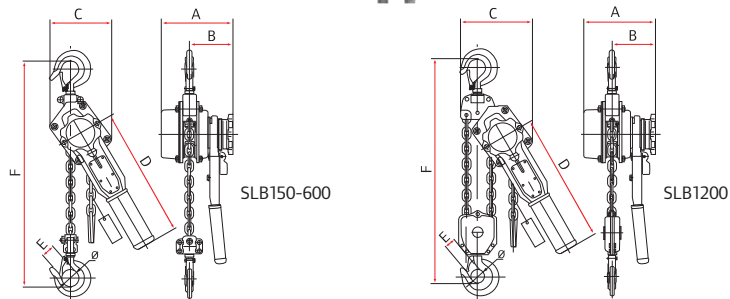

MODEL	RATED CAPACITY	PULL TO LIFT RATED LOAD	NO. OF CHAIN FALLS	A		B		C		D		E		F (min)		LOAD CHAIN SIZE	
	Metric tons (lb)			mm (in)	mm (in)	mm (in)	mm (in)	mm (in)	mm (in)	mm (in)	mm (in)	mm (in)	mm (in)	mm (in)	mm (in)	mm (in)	
SLB150	3/4 (1,650)	41	1	158 (6.2)	93 (3.6)	132 (5.2)	308 (12.1)	29 (1.1)	330 (13)	37 (1.5)	6 X 18 (0.24 x 0.71)						
SLB200	1 (2,200)	60	1	163 (6.4)	95 (3.7)	140 (5.5)	308 (12.1)	32 (1.3)	365 (14.4)	40 (1.6)	6 X 18 (0.24 x 0.71)						
SLB300	1-1/2 (3,300)	53	1	185 (7.3)	106 (4.2)	145 (5.7)	378 (14.9)	35 (1.4)	400 (15.7)	45 (1.8)	7.1 x 21.2 (0.28 x 0.84)						
SLB600	3 (6,600)	53	1	212 (8.4)	118 (4.6)	199 (7.8)	418 (16.5)	44 (1.7)	520 (20.5)	55 (2.2)	10 x 30 (0.39 x 1.18)						
SLB1200	6 (13,200)	57	2	212 (8.4)	118 (4.6)	230 (9.1)	418 (16.5)	50 (2)	640 (25.2)	65 (2.6)	10 x 30 (0.39 x 1.18)						

Distributed by:

